

FOR CONTINUATION,  
 SEE DRAWING NO. 0001

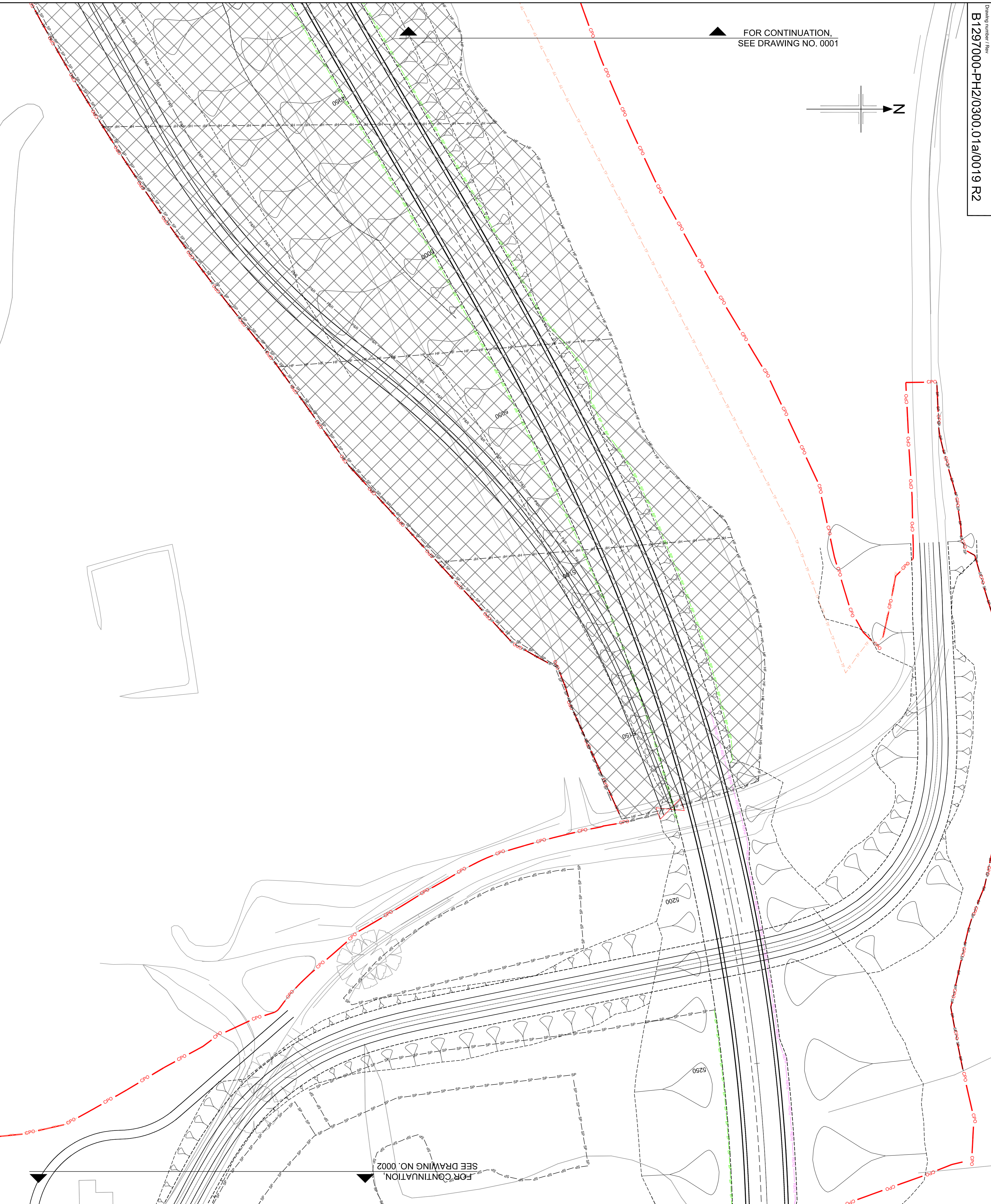
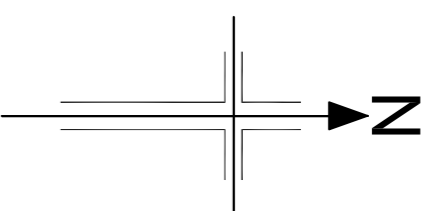

- NOTES**
1. Refer to drawing number B1297000/0300.01a/0000 for Key plan drawings are to be used in conjunction with Appendix
  2. 3/1 Fencing, Gates and Sills
  3. Stock Proof Fencing- It has been assumed that all Agricultural fencing requires stock proof fencing; this is to be reviewed following confirmation of land use/maintenance.
  4. Gates- The location and provision of gates and sills are to be confirmed.
  5. Noise Barrier to be placed on highway boundary, or offset up to 1m inside highway boundary subject to agreement with adjacent landowners.
  6. Noise Barrier- Close boarded timber noise attenuation barrier.
  7. Badger gates- One way badger gates to be provided along the route of the link road at a minimum of 500m spacing on both side of the link road.
  8. Badger proof fencing to taper towards mammal tunnel entrances.
  9. Where stock proof / noise proof fencing and badger fencing are required in close proximity a design solution to combine fence types will be considered.

**KEY**

	CPO Boundary
	Standard timber post and Rail
	Stock Proof
	Badger Proof
	Stock/Badger Proof
	Bat Fence
	Temporary Fence
	Timber Post and Wire
	Absorptive Noise Barrier
	Reflective Noise Barrier (Height - 1.8m)
	Reflective Noise Barrier (Height - 1.5)
	Hempile Fence
	Gate
	Badger Gate (2 way)
	Noise Bund
	Temporary Fencing SSSI

**SAFETY, HEALTH AND ENVIRONMENTAL INFORMATION**

In addition to the manufacturer's normally associated with the type of work detailed on this drawing, note the following:

**CONSTRUCTION**

**MAINTENANCE / CLEANING**

**DECOMMISSIONING / DEMOLITION**

It is assumed that all works will be carried out by a competent contractor working, where appropriate, to an approved method statement.

Reproduction from the Ordnance Survey Map with the permission of the controller of Her Majesty's Stationery Office Crown copyright reserved Licence No. AL 100017326



Rev	Rev. Date	Purpose of revision	Drawn	Checked	Rev'd	App'd
R2	14/12/2012	ISSUE FOR INFORMATION	DM	RS	SG	RD
R1	12/11/2012	ISSUE FOR INFORMATION	DM	RS	SG	RD
RD	02/11/2012	INITIAL ISSUE	DC	DM	RS	RD

**JACOBS**

Simpson House, 6 Cherry Orchard Road, Gorton, Surrey, CR9 6BE  
 Tel: +44(0)2081 661 8212 Fax: +44(0)2081 661 2499  
 www.jacobs.com

Client: **HOCHTIEF** **TEVA** **LABS** **UK**

Project: **BEXHILL TO HASTINGS LINK ROAD**

Drawing title: **FENCING**

Drawing site: **SHEET 19 OF 32**

Drawing status: **ISSUE FOR REVIEW**

Scale: **1:500 @ A1**

Jacobs No.: **B1297000-PH2**

Client no.: **DO NOT SCALE**

Drawing number: **B1297000-PH2/0300.01a/0019**

Rev: **R2**

This drawing is not to be used in whole or part other than for the intended purpose and project as defined on this drawing. Refer to the contract for full terms and conditions.